

LSTE4/5

ELECTRONIC TRANSFORMER UNIT

COMPATIBILITY GUIDE

FIXTURE	MAXIMUM WATTAGE	MOUNT	UNIT
LS441A	50W	WALL	LSTE4



WALLMOUNT

A.C.N. 010 572 773



LIGHTING DESIGNER	FITTING REFERENCE
SUPPLIER	

FEATURES

- High Pressure Die Cast Aluminium Body
- Integral terminal connections
- Self re-setting internal thermal cut-out
- Over supply protection
- Manufactured to IP64 water protection (when fitted with cable gland.)
- Stainless Steel fasteners

TRANSFORMER SPECS.

Hybrid IC Technology

Prim: 240V~50/Hz 0.33A
 Sec: 11.5V~eff 6.3A
 Cos/ϕ = 0.98, ta 40° tc 78°



SELV



LUMASCAPE

LUMASCAPE LIGHTING INDUSTRIES PTY LTD

Head Office and Factory
 38-44 Enterprise Street, Cleveland,
 QLD Australia 4163
 PO Box 1875, Cleveland D.C.,
 QLD Australia 4163
 Tel 07 3286 2299 Fax 07 3286 6599

International
 Telephone 61 7 3286 2299
 Fax 61 7 3286 6599

New South Wales
 Tel (02) 9519 6860 Fax (02) 9519 8834

Victoria
 Tel (03) 9686 1900 Fax (03) 9686 1700

North America
 Vertex Lighting Inc
 Tel (514) 331-6441 Fax (514) 331-7002

ABN: 21 010 572 773

DETAIL DRAWING

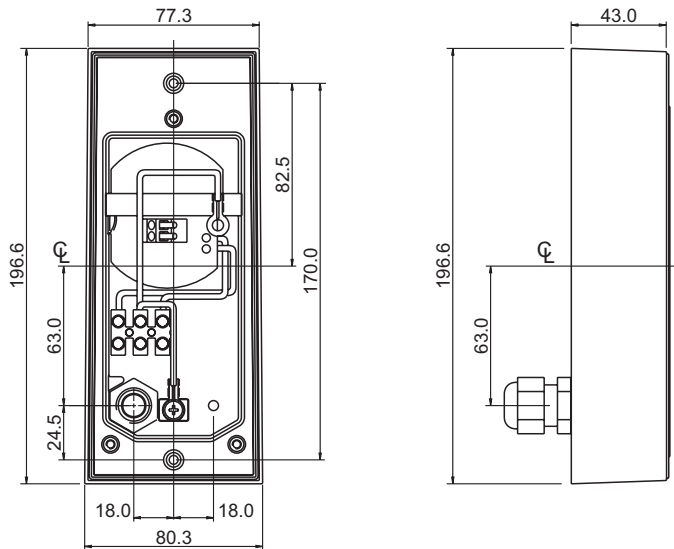

SPECIFICATION

DESCRIPTION	CATALOGUE NO:
NOTES	LAMP
	COLOUR

Lumascap Lighting Industries will guarantee the following product groups from the date of purchase against faulty workmanship or materials for: 1. Underwater-5 years 2. Copper-10 years 3. Aluminium-2 years 4. Stainless Steel-10 years Structural/12 months Electrical. All warranty claims must be returned to Lumascap Lighting Industries for assessment. There is no warranty offered on lamps other than lamp manufacturers warranty if any. Lumascap Lighting Industries accepts no responsibility for damage to any ancillary equipment or inconvenience caused by the failure of our products. Lumascap Lighting Industries reserves the right to alter fittings or specifications at any time.

www.lumascap.com.au